



Cabell Gateway Building
4,915 Sq. Ft. Available
3135 16th Street Rd
Huntington, West Virginia
(Cabell County)

LOCATION

Adjacent to I-64 at the Sixteenth Street/
Hal Greer Exit II in Huntington, WV.
Located on Alternate Rt. 10.
Building is visible from Interstate 64.
Downtown within 2 miles.
Tri-State Airport is approximately 10 miles.

DESCRIPTION

4,915 sq. ft . available Jan. 1, 2010 on 1st floor.
2-story building.
Located on 2.132 acre site.
144 on-site parking spaces available.

UTILITIES

Electric: AEP
440, 3-Phase available
Gas: Allegheny Power
3" line
Water: WV American Water
Sewer: Pending City of Huntington

TERMS

Lease Only: Negotiable

CONTACT

Huntington Area Development Council
916 Fifth Avenue, Suite 400
Huntington, WV 25701
Phone: 304-525-1161
Fax: 304-525-1163
E-mail: hadco@hadco.org

The information listed above has been provided by third party sources. HADCO has not independently researched such information and, therefore, cannot warrant its accuracy.

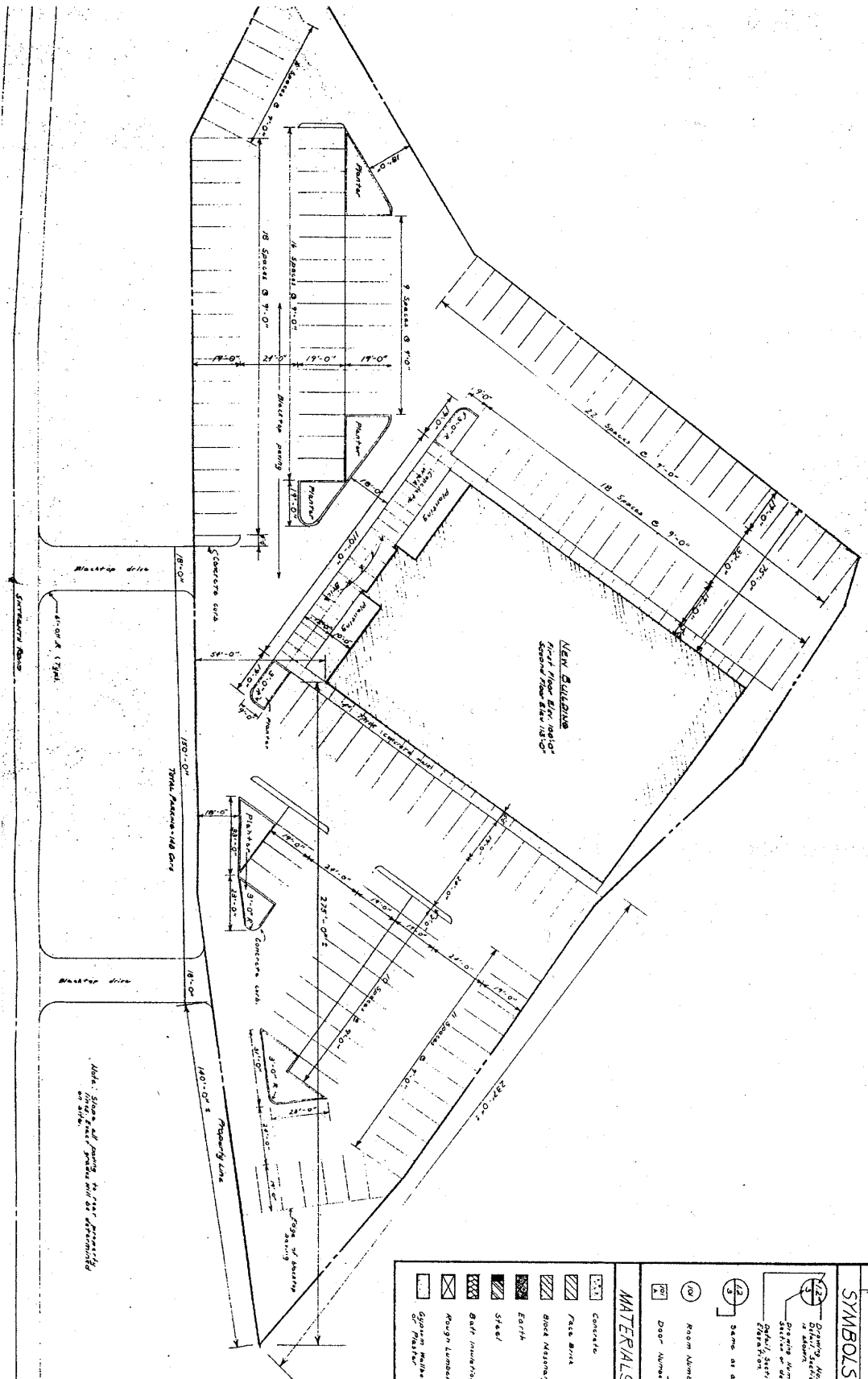

Note: Show all rooms in the present plan as shown on site. Actual dimensions will be determined on site.

SYMBOLS LEGEND

- ① Drawing Number shown in above
- ② Drawing Number shown in above
- ③ Same as above
- ④ Room Number
- ⑤ Door Number
- ⑥ East Elevation
- ⑦ North Elevation
- ⑧ South Elevation
- ⑨ West Elevation
- ⑩ Spring Section
- ⑪ Section of
- ⑫ Section of

MATERIALS LEGEND

- Concrete
- Face Brick
- Brick Masonry
- Earth
- Steel
- Dark masonry
- Rough Lumber
- Open Plaster
- Finish L. mason
- Plaster
- Availing ceiling
- 9" masonry
- 12" masonry
- 18" masonry
- 24" masonry
- 36" masonry
- 48" masonry
- 60" masonry
- 72" masonry
- 84" masonry
- 96" masonry
- 108" masonry
- 120" masonry
- 132" masonry
- 144" masonry
- 156" masonry
- 168" masonry
- 180" masonry
- 192" masonry
- 204" masonry
- 216" masonry
- 228" masonry
- 240" masonry
- 252" masonry
- 264" masonry
- 276" masonry
- 288" masonry
- 300" masonry
- 312" masonry
- 324" masonry
- 336" masonry
- 348" masonry
- 360" masonry
- 372" masonry
- 384" masonry
- 396" masonry
- 408" masonry
- 420" masonry
- 432" masonry
- 444" masonry
- 456" masonry
- 468" masonry
- 480" masonry
- 492" masonry
- 504" masonry
- 516" masonry
- 528" masonry
- 540" masonry
- 552" masonry
- 564" masonry
- 576" masonry
- 588" masonry
- 600" masonry

REVISIONS